

YOU WILL NEED

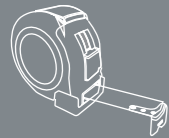

Measuring Tape



Notepad

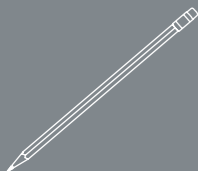

Pencil

ROMAN BLINDS MEASURING GUIDE

Here are some step by step instructions for how to measure your window for your new Roman blind. Firstly, choose whether you wish your blind to be inside or outside the recess.

INSIDE THE RECESS

- Measure the width at 3 points across the top, middle and bottom.
- Record the smallest size.
- Measure height at 3 points across the right, centre and left.
- Record the smallest size.

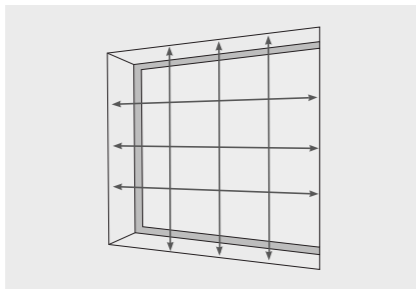

IMPORTANT NOTES:

- Do not make any deductions from you measurements.
- If you have any obstructions within your recess, e.g. tiles, measure between these two points and use this as your width measurement.

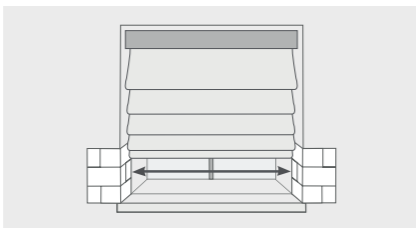

- Ensure you leave enough clearance between the front of your window recess and the edge of any obstruction.
- When fitting a Unishade or Unishade Breakaway system, you will need to leave at least 5 cm of clearance. For a Cruze Cassette system, you will need to leave at least 8.5cm of clearance.

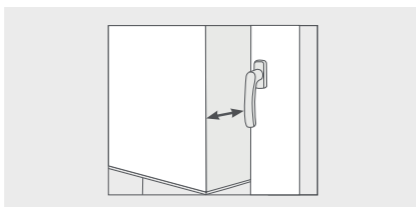

OUTSIDE THE RECESS

- To fit outside the recess, the exact size of the blind is required.
- Measure the width of required blind and include left and right overlap.
- Measure the drop of required and include top and bottom overlap.

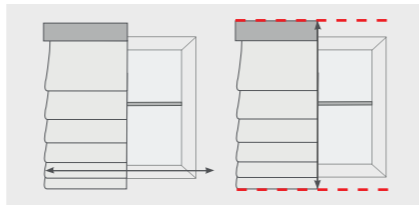

IMPORTANT NOTES:

- **Left and Right Overlap:** We recommend your blind overlaps the window recess by at least 5cm on each side (10cm overall). You will eliminate more light the more the blind overlaps the recess.

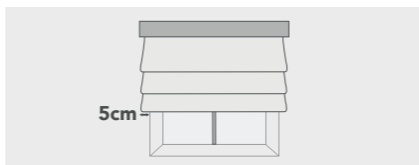

- **Top Overlap:** We recommend your blind overlaps the top of the window by at least 7cm.

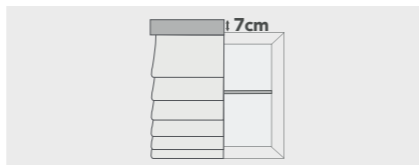

- **Bottom Overlap:** If your window sill protrudes more than 5cm, you should stop your blind at this point. Be aware of obstructions such as radiators when measuring your drop.

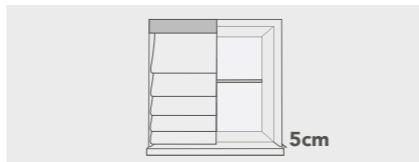

WARNING

Young children can be strangled by loops in pull cords, chains, tapes and inner cords that operate the product. To avoid strangulation and entanglement, keep cords out of the reach of young children. Cords may become wrapped around a child's neck. Move beds, cots and furniture away from window covering cords. Do not tie cords together. Make sure cords do not twist and create a loop.

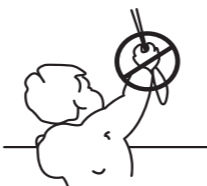

FOLLOW THE INSTRUCTIONS AND REMEMBER TO DOUBLE CHECK YOUR MEASUREMENTS AS YOU GO ALONG



ROMAN BLINDS